

Oval-Lo^c™

A new type of Tog-L-Lo^c® - where strength meets style.



Oval-Lo^c™ was born from the vision of combining our popular Tog-L-Lo^c® round clinch joint with the rotation resistance of our Lance-N-Lo^c™ sheet metal joining system. The Oval-Lo^c™ process combines the leak-proof and long tool life characteristics of a traditional Tog-L-Lo^c® joint, but features improved strength and durability.

Contact BTM today to learn more about Oval-Lo^c™ clinching!

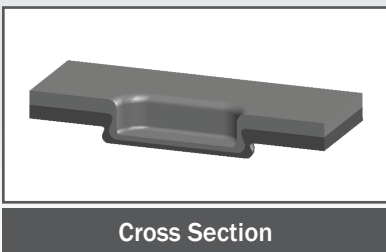

Cross Section

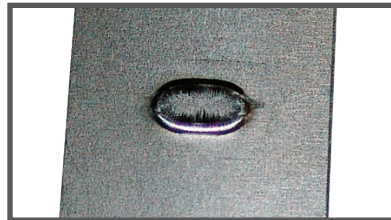

Die Side

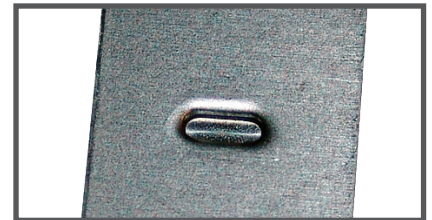

Punch Side

Tog-L-Lo^c®
SHEET METAL JOINING SYSTEM

www.Tog-L-Loc.com

BTM®
CORPORATION

www.BTMcorp.com

810-364-4567