

Clinching Application Questionnaire



Thank you for your interest in working with BTM Company! Completion of this form will assist in evaluating your parts and determining how to best assemble them utilizing BTM Clinch Tooling. Upon receipt of this completed form along with coupons/samples, BTM will join your parts and return them with strength data and an estimate of tool costs. Please contact BTM with any questions you may have regarding this form or your application.

Your Name: _____ Company: _____ Date: / / _____

Address: _____ **Please Ship To:**
 Tel: () _____ Email: _____ Material Joining Lab
 Product Description: _____ BTM Company, LLC
 BTM Contact: _____ 300 Davis Rd.
 Marysville, MI 48040
 Att'n: Bill Jowett

***EACH LAYER being joined requires 40 coupons at 25mm [1"] x 100mm [4"] for shear & peel strength testing.**

Examples:

- Punch side 1.5mm Aluminum joined to die side 1mm Steel: 40 Aluminum coupons + 40 Steel coupons = **80 total**
- Punch side 1mm Aluminum to die side 1mm Aluminum: 40 punch side coupons + 40 die side coupons = **80 total**

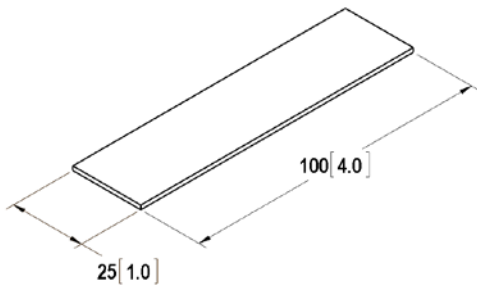

Coupon

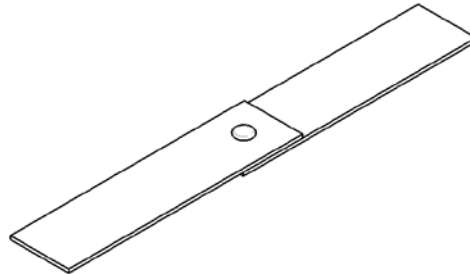

Shear

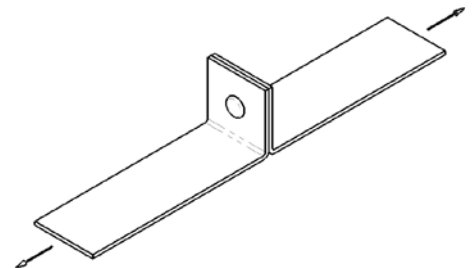

Peel

Material Example: 1.5mm 6016 T4 Aluminum, Hardness Rockwell F68

Punch Side Metal Thickness, Type, and Hardness: _____

Die Side Metal Thickness, Type, and Hardness: _____

List Additional Materials If More Than 2 Layers: _____

Is the part a structural component? Yes No

Is this a new product design? Yes No

Is this currently in production? Yes No

If yes, what fastening method is currently used? _____

Number of assemblies to be produced per year: _____

When will production of this assembly be required? _____

Would you like BTM to offer suggestions regarding the parts design if we feel that a change would simplify your joining tool and or process? Yes No

Sketch: If possible, please attach a sketch or printout. Indicate location of joints, distances between joints, side to punch, and any other pertinent information.